

TYPE	ITEM NO.	ITEM NAME	WEIGHT (KG)
------	----------	-----------	-------------

Figure No.

186

Rammer S18/ Piccolo

Kubota KXB300/350, Volvo HB80

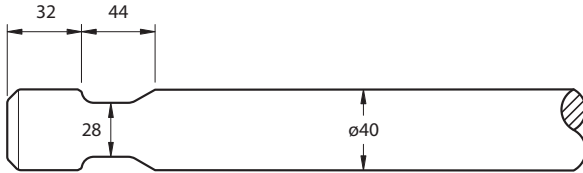

Point 400
Chisel 400

D070-0400P
D070-0400C

4
4

187

Rammer S21

Caterpillar H45FT, Bobcat 1750, Case CB140, JCB HM160, Kubota KXB400/BTB400, O&K H32, Volvo HB130

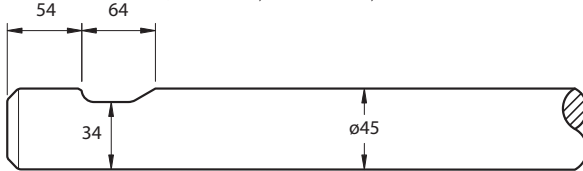

Point 480
Point 560
Chisel 480
Chisel 560

D071-0480P
D071-0560P
D071-0480C
D071-0560C

5
6
5
6

188

Rammer S22

Caterpillar H50FT, Case CB200, Kubota KXB450, O&K H45, Volvo HB200

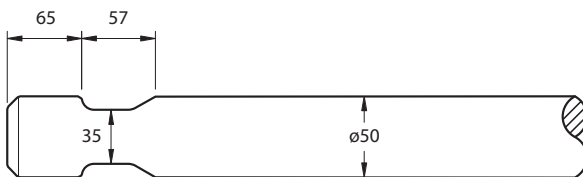

Point 530
Point 600
Chisel 530
Chisel 600

D091-0530P
D091-0600P
D091-0530C
D091-0600C

8
9
8
9

189

Rammer S23

Caterpillar H63/H63FT, Case CB370, JCB HM260, Kubota KXB500, O&K H65, Volvo HB300

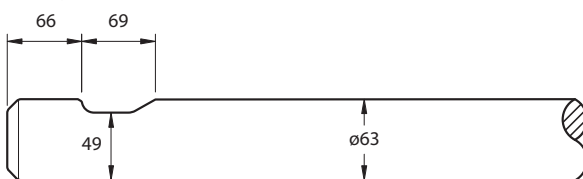

Point 680
Point 780
Chisel 680
Chisel 780

D073-0680P
D073-0780P
D073-0680C
D073-0780C

15
17
15
17

190

Rammer S25

Caterpillar H70/H70FT, Case CB620, JCB HM360, Kubota KXB600, O&K H85, Volvo HB440

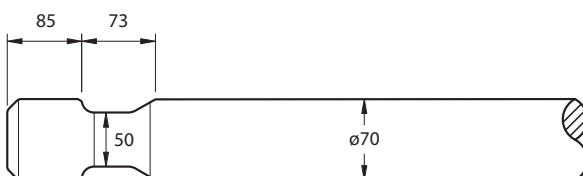

Point 730
Point 830
Chisel 730
Chisel 830

D075-0730P
D075-0830P
D075-0730C
D075-0830C

20
23
20
23

191

Rammer S26

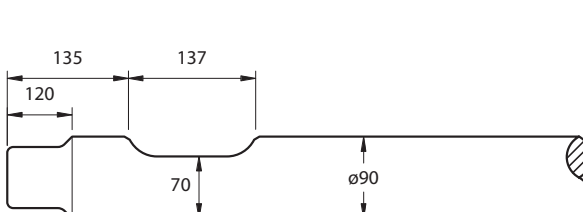

Point 850
Chisel 850

D076-0850P
D076-0850C

35
35

Figure No.

TYPE	POINT	CHISEL	BLUNT	WEIGHT (kg)
------	-------	--------	-------	-------------

192

Rammer S27

Caterpillar H90/H90FT, Case CB735, JCB HM550, O&K H120, Volvo HB600

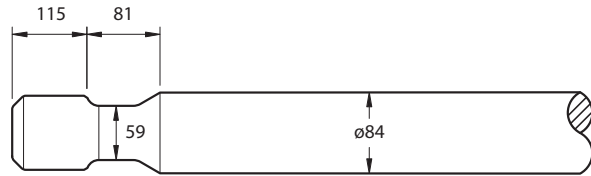

Point 840
Chisel 840

D087-0840P
D087-0840C

34
34

193

Rammer S29

Caterpillar H100/H100FT, Case CB1150, JCB HM850, O&K H150, Volvo HB800

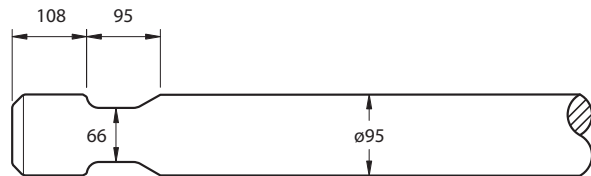

Point 900
Chisel 900

D090-0900P
D090-0900C

47
47

194

Rammer S52

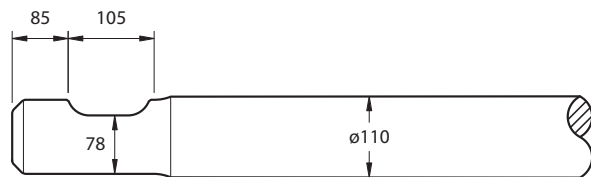

Point 900
Chisel 900

D077-0900P
D077-0900C

55
55

195

Rammer S54

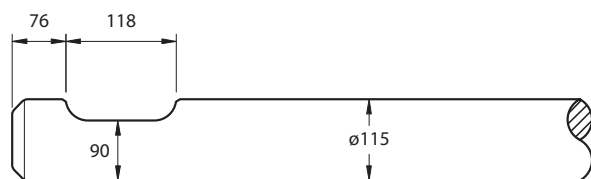

Point 1050
Chisel 1050

D078-1050P
D078-1050C

80
80

196

Rammer S55/E66

Caterpillar H120s, Case CB2850, JCB HM1350, O&K H260

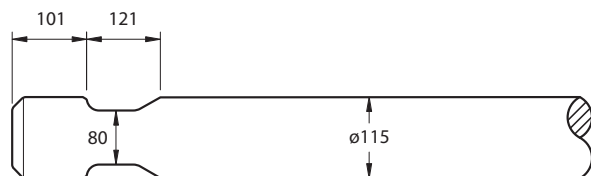

Point 1050
Point 1150
Chisel 1050
Chisel 1150
Blunt 950

D079-1050P
D079-1150C
D079-1050C
D079-1150C
D079-0950B

80
88
80
88
73

197

Rammer S56

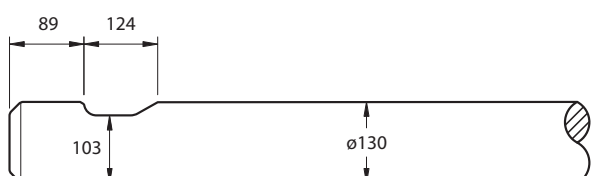

Point 1100
Chisel 1100
Blunt 1000

D080-1100P
D080-1100C
D080-1000C

102
102
93

TYPE	WEIGHT (kg)	PART NUMBER	WEIGHT (kg)
------	-------------	-------------	-------------

Figure No.

198

Rammer S82

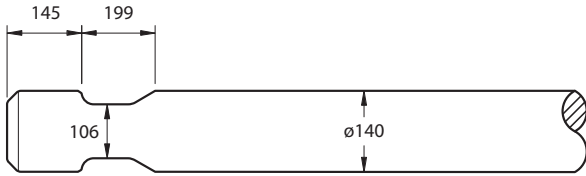

Point	1200	D081-1200P	137
Chisel	1200	D081-1200C	137
Blunt	1050	D081-1050B	122

199

Rammer S83

Caterpillar H140As

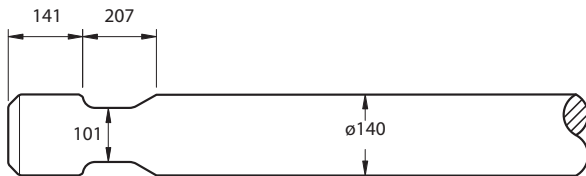

Point	1200	D082-1200P	137
Chisel	1200	D082-1200C	137
Blunt	1050	D082-1050B	122

200

Rammer S84

Caterpillar H160As

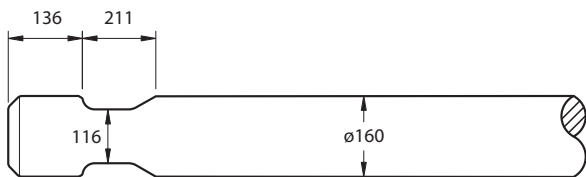

Point	1350	D084-1350P	195
Chisel	1350	D084-1350C	195
Blunt	1200	D084-1200B	173

201

Rammer S86

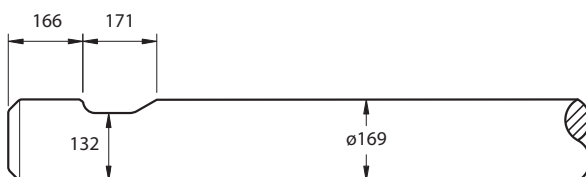

Point	1450	D085-1450P	240
Chisel	1450	D085-1450C	240
Blunt	1300	D085-1300B	215

202

Rammer E63

JCB HM1150, Volvo HB1100

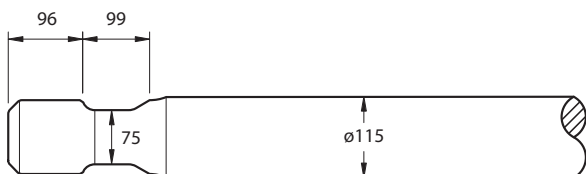

Point	1000	D099-1000P	68
Chisel	1000	D099-1000C	68

203

Rammer E64

Caterpillar H115s, Case CB1450, JCB HM1050, O&K H200



Point	1050	D088-1050P	64
Point	1150	D088-1150P	70
Chisel	1050	D088-1050C	64
Chisel	1150	D088-1150C	70

Figure No.

TYPE	ITEM NO.	ITEM CODE	WEIGHT (KG)
------	----------	-----------	-------------

204

Rammer E65

JCB HM1450, Volvo HB1400

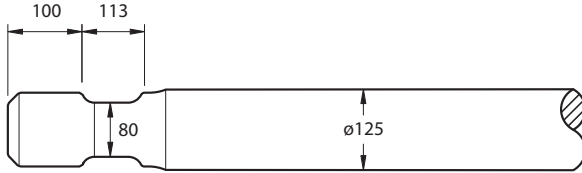

Point	1050
Chisel	1050
Blunt	850

D095-1050P	80
D095-1050C	80
D095-0850B	69

205

Rammer E66/S55

Caterpillar H120s, Case CB2850, JCB HM1350, O&K H260

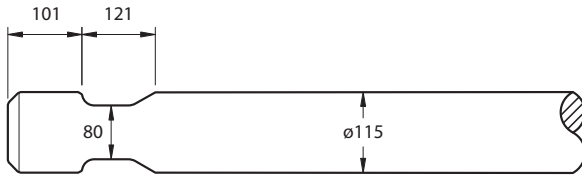

Point	1050
Point	1150
Chisel	1050
Chisel	1150
Blunt	950

D079-1050P	80
D079-1150C	88
D079-1050C	80
D079-1150C	88
D079-0950B	73

206

Rammer E68

Caterpillar H130s, Case CB3750, JCB HM1750, O&K H310, Volvo HB1700

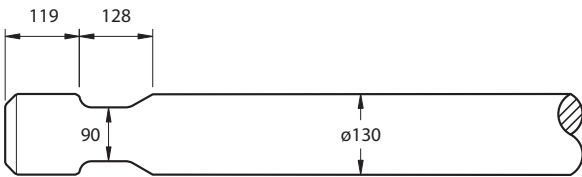

Point	1100
Point	1200
Chisel	1100
Chisel	1200
Blunt	900

D086-1100P	102
D086-1200P	111
D086-1100C	102
D086-1200C	111
D086-0900B	84

207

Rammer G80

Caterpillar H140Cs/140Ds, Case CB4000, JCB HM2350, O&K H380, Volvo HB2400

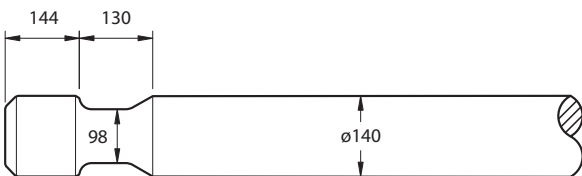

Point	1200
Chisel	1200
Blunt	1050

D092-1200P	137
D092-1200C	137
D092-1050B	122

208

Rammer G90

Caterpillar H160Cs/160Ds, Case CB5200, JCB HM2950, O&K H530, Volvo HB3200

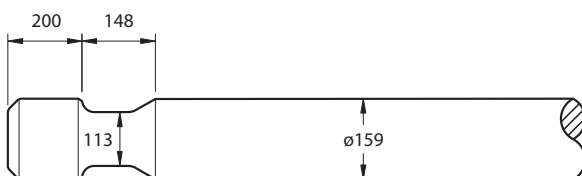

Point	1400
Chisel	1400
Blunt	1250

D094-1400P	206
D094-1400C	206
D094-1250B	184

209

Rammer G100

Caterpillar H180s, JCB HM3850

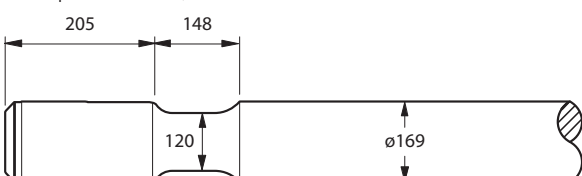

Point	1450
Chisel	1450
Blunt	1300

D089-1450P	240
D089-1450C	240
D089-1300B	215

TYPE	WEIGHT (kg)	PART NUMBER	WEIGHT (kg)
------	-------------	-------------	-------------

Figure No.

210

Rammer G110

Caterpillar H180Ds, JCB HM3950, O&K H700, Volvo HB3800

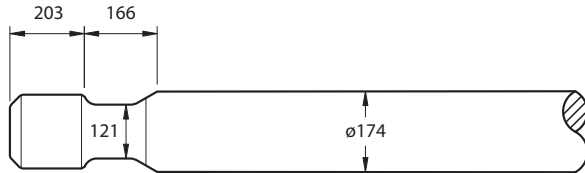

Point	1450
Chisel	1450
Blunt	1300

D096-1450P	240
D096-1450C	240
D096-1300B	216

211

Rammer G120

Caterpillar H195

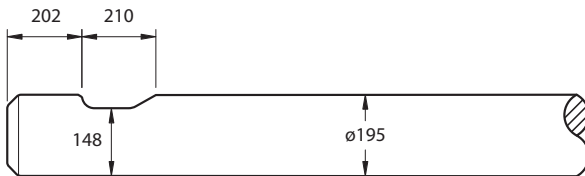

Point	1500
Chisel	1500
Blunt	1350

D093-1500P	326
D093-1500C	326
D093-1350B	294

212

Rammer G130

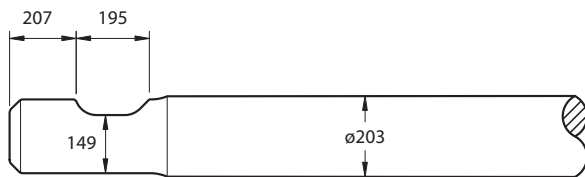

Point	1550
Chisel	1550
Blunt	1400

D097-1550P	340
D097-1550C	340
D097-1400B	308

213

Rammer M14

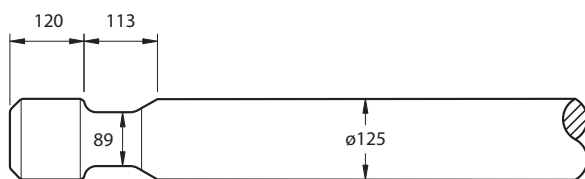

Point	1100
Chisel	1100

D800-1100P	92
D800-1100C	92

214

Rammer M18

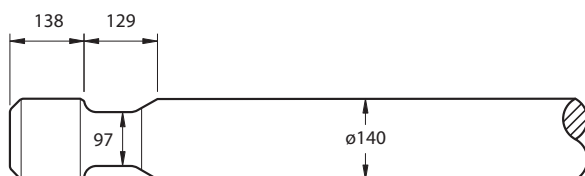

Point	1200
Chisel	1200
Blunt	1100

D801-1200P	137
D801-1200C	137
D801-1100B	126