

TYPE	ITEM NO.	ITEM NAME	WEIGHT (KG)
------	----------	-----------	-------------

Figure No.

### Atlas Copco PB110

Berco BB42, Chicago Pneumatic CP100, Krupp AT20

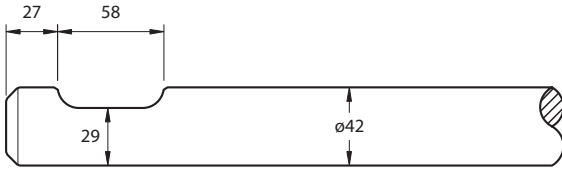

Point 470  
Chisel 470

D062-0470P  
D062-0470C

4  
4

### Atlas Copco PB160

Berco BB52, Chicago Pneumatic CP150, Krupp AT70

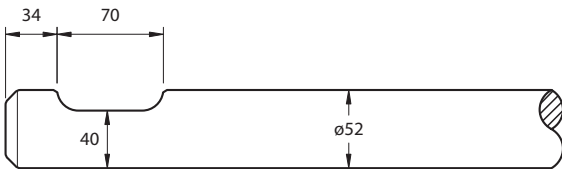

Point 600  
Chisel 600

D063-0600P  
D063-0600C

8  
8

### Atlas Copco PB210

Berco BB62, Chicago Pneumatic CP200, Krupp AT120

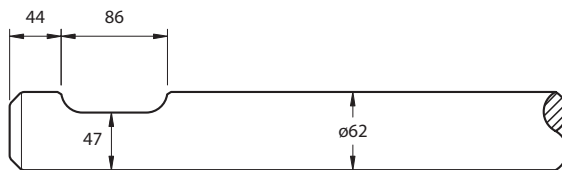

Point 700  
Chisel 700

D064-0700P  
D064-0700C

14  
14

### Atlas Copco PB310

Berco BB70, Chicago Pneumatic CP300, Krupp AT170

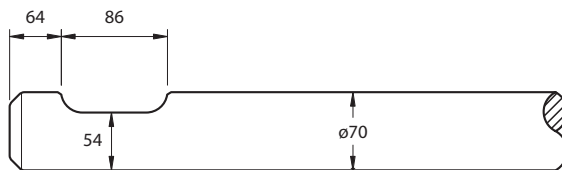

Point 750  
Chisel 750

D065-0750P  
D065-0750C

21  
21

### Atlas Copco PB420

Berco BB80, Chicago Pneumatic CP400/550, Krupp AT220, HM220/230

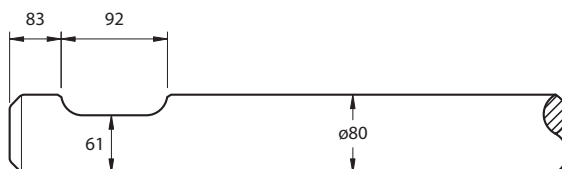

Point 900  
Chisel 900

D061-0900P  
D061-0900C

29  
29

### Atlas Copco SB50

Atlas Copco SBC60, Tex30H

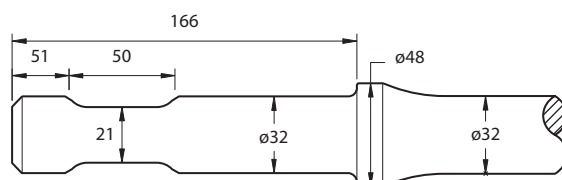

Point 430  
Chisel 430

D233-0430P  
D233-0430C

2  
2

Figure No.

TYPE	WEIGHT (KG)	ITEM CODE	WEIGHT (KG)
------	-------------	-----------	-------------

### Atlas Copco SB100

Atlas Copco SBC115, TEX75H / 100H

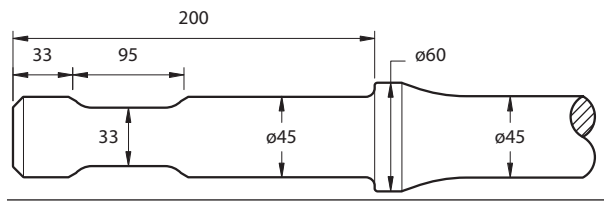

Point 550  
Chisel 550

D222-0550P  
D222-0550C

5  
5

### Atlas Copco SB150

Atlas Copco SBC255, TEX110H

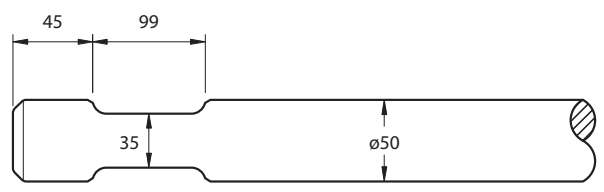

Point 550  
Chisel 550

D230-0550P  
D230-0550C

7  
7

### Atlas Copco SB200

Atlas Copco SBC410, TEX180H

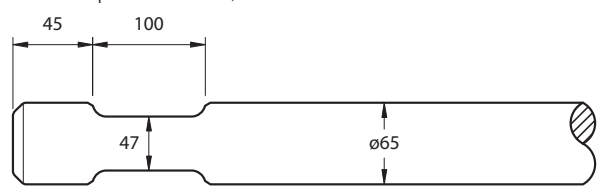

Point 600  
Chisel 600

D229-0600P  
D229-0600C

13  
13

### Atlas Copco SB300

Atlas Copco SBC610, SBC650

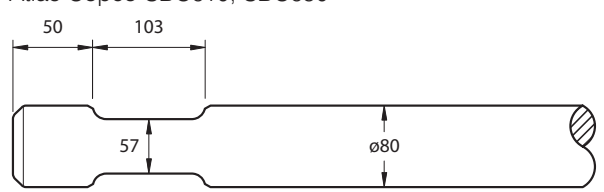

Point 800  
Chisel 800  
Blunt 800

D232-0800P  
D232-0800C  
D232-0800B

27  
27  
27

### Atlas Copco SB300 Scaler

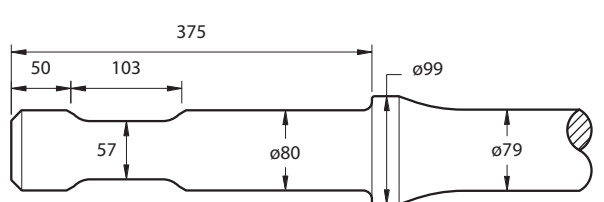

Blunt 800

D235-0800B

28

### Atlas Copco Tex 250H

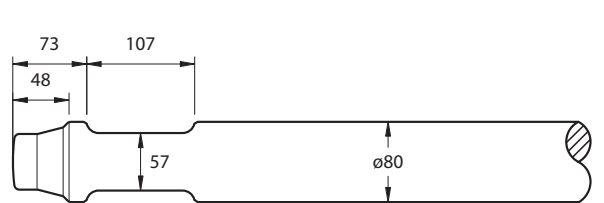

Point 800  
Chisel 800

D224-0800P  
D224-0800C

27  
27

7

8

9

10

11

12

TYPE	LENGTH	SHAFT TUBE NUMBER	WEIGHT (KG)
------	--------	-------------------	-------------

Figure No.

### Atlas Copco Tex 250H Scaler

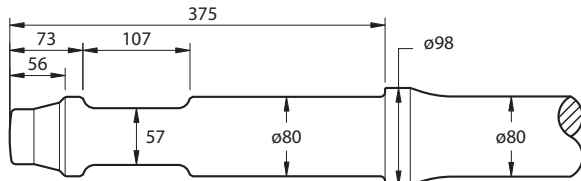

Blunt	800	D224-0800B	28
-------	-----	------------	----

### Atlas Copco SB450

Atlas Copco SBC800/850, Tex 400H

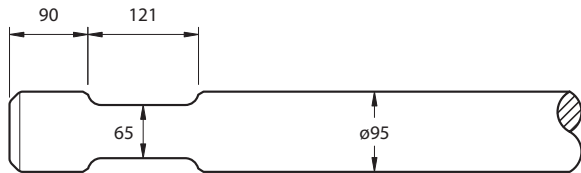

Point	840	D231-0840P	43
Chisel	840	D231-0840C	43
Blunt	840	D231-0840B	43

### Atlas Copco HBC1100/1700

Atlas Copco Tex 600H, 700H, 900H

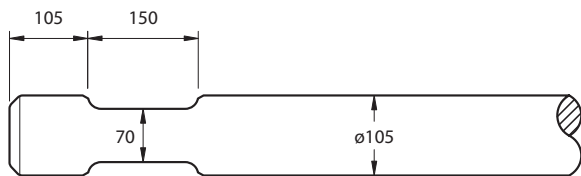

Point	900	D226-0900P	60
Chisel	900	D226-0900C	60
Blunt	900	D226-0900B	60

### Atlas Copco HBC2500

Atlas Copco Tex 1400H

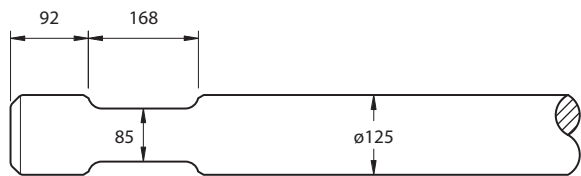

Point	1000	D227-1000P	95
Chisel	1000	D227-1000C	95
Blunt	1000	D227-1000B	95

### Atlas Copco HBC4000

Atlas Copco Tex 1800H/2000H

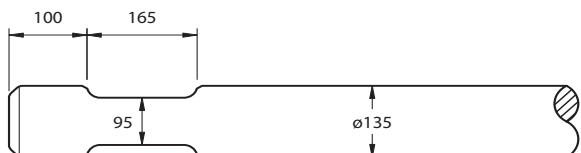

Point	1100	D228-1100P	119
Chisel	1100	D228-1100C	119
Blunt	1100	D228-1100B	119

### Atlas Copco HBC6000

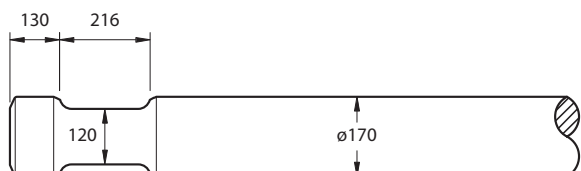

Point	1500	D234-1500P	245
Chisel	1500	D234-1500C	245
Blunt	1500	D234-1500B	245

TYPE	ITEM NO.	ITEM CODE	WEIGHT (KG)
------	----------	-----------	-------------

Figure No.

19

### Atlas Copco MB500

Krupp HM350

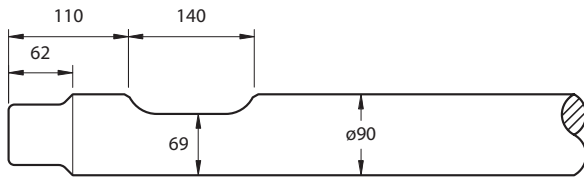

Point 900  
Chisel 900

D051-0900P  
D051-0900C

36  
36

20

### Atlas Copco MB700/MB800

Krupp HM580, Chicago Pneumatic CP750

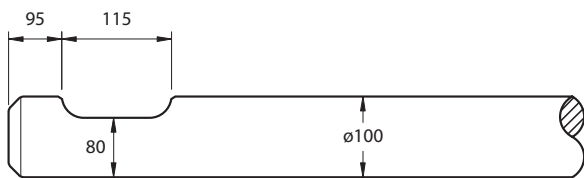

Point 1000  
Chisel 1000  
Blunt 1000

D058-1000P  
D058-1000C  
D058-1000B

55  
55  
55

21

### Atlas Copco MB1000

Krupp HM680

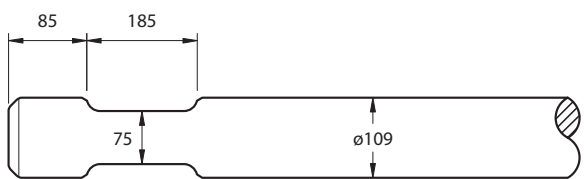

Point 1050  
Chisel 1050  
Blunt 1050

D067-1050P  
D067-1050C  
D060-1050B

61  
61  
61

22

### Atlas Copco MB1200

Krupp HM780

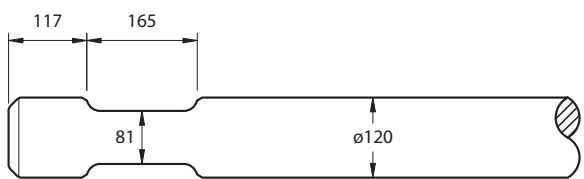

Point 1150  
Chisel 1150  
Blunt 1150

D059-1150P  
D059-1150C  
D059-1150B

94  
94  
94

23

### Atlas Copco MB1700

Krupp HM1000



Point 1200  
Chisel 1200  
Blunt 1200

D053-1200P  
D053-1200C  
D053-1200B

137  
137  
137

24

### Atlas Copco HB2200

Krupp HM1500, Chicago Pneumatic CP2250

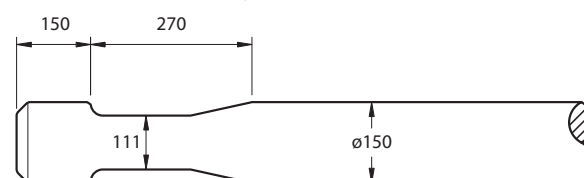

Point 1300  
Chisel 1300  
Blunt 1300

D055-1300P  
D055-1300C  
D055-1300B

178  
178  
178

TYPE	WEIGHT (KG)	ITEM NO.	ITEM NO.	WEIGHT (KG)
------	-------------	----------	----------	-------------

Figure No.

25

### Atlas Copco HB3000

Krupp HM2300, Chicago Pneumatic CP3050

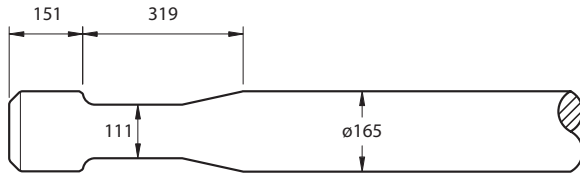

Point	1500
Chisel	1500
Blunt	1500

D060-1500P	223
D060-1500C	223
D060-1500B	223

26

### Atlas Copco HB4200

Krupp HM2600, Chicago Pneumatic CP4250

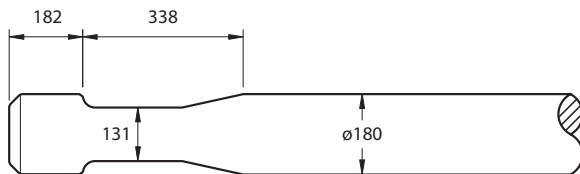

Point	1500
Chisel	1500
Blunt	1500

D057-1500P	300
D057-1500C	300
D057-1500B	300

27

### Atlas Copco HB5800

Krupp HM3000

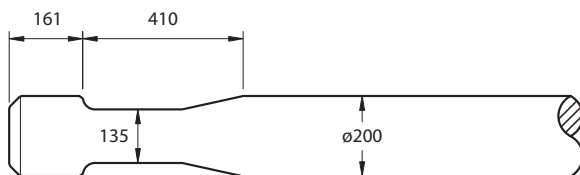

Point	1700
Chisel	1700
Blunt	1700

D066-1700P	405
D066-1700C	405
D066-1700B	405

28

### Atlas Copco HB7000

Krupp HM4000

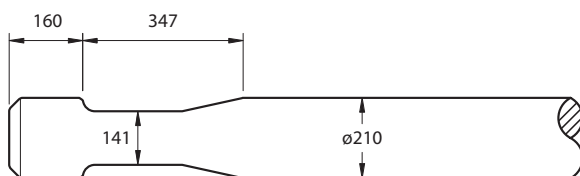

Point	1800
Chisel	1800
Blunt	1800

D052-1800P	458
D052-1800C	458
D052-1800B	458